

Structural Engineers
**JOHNSON, LEWISON,
 & ASSOCIATES, INC.**
 1450 Collins Blvd., Suite 300
 W. Palm Beach, FL 33411
 (561) 989-2535

Civil Engineers
**DEFRONTE CONSULTING,
 INC.**
 2289 Appleton Rd.
 West Palm Beach, FL 33411
 (561) 752-3231

Landscaping Architecture
**ROBERTS
 & ROBERTS, INC.**
 2982 Seaside Avenue, Suite 200
 Coconut Grove, FL 33133
 (305) 452-1724

Project
**Boynnton Beach
 CONGRESS
 MIDDLE SCHOOL**

Architect
Zyscovich
 100 North Biscayne Blvd., 27th Floor, Miami, FL 33132
 Voice 305.372.5222 Fax 305.577.4821 mail@zyscovich.com
 Reg. No. AC0011431

Scale
 Reg. No. AR-10670

Copyright © 2004 Zyscovich, Inc. All rights reserved. This drawing and specification are instruments of service and shall remain the property of Zyscovich, Inc. unless otherwise stated. No part of this drawing may be reproduced or transmitted in any form or by any means, electronic or mechanical, including photocopying, recording, or by any information storage and retrieval system, without the prior written permission of Zyscovich, Inc. Approval of this drawing by the Florida Board of Architecture is not a representation of the Florida Board of Architecture.

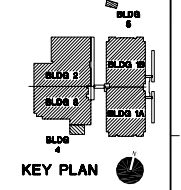

Overall
**OVERALL
 SITE PLAN
 PHASE III**

0338CONG 10/08/04

A-101.2

PHASE III - 100% CONSTRUCTION DOCUMENTS



OVERALL SITE PLAN - PHASE III
 A-100 Scale: 1" = 50'-0"